

TYPE H CONTINENTAL DIN 15233

Industrial Pressed Steel Bucket.

- > Supplied complete with standard recessed holes
- > Low front and open profile
- > Ideal for handling difficult, sticky industrial materials

PRESSED SEAMLESS STEEL

Industrial

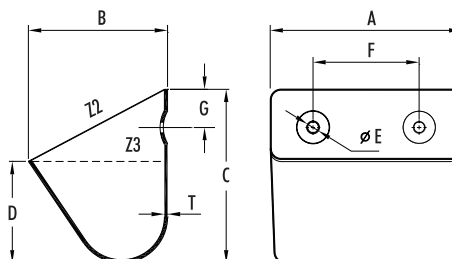

No.	A* (mm)	B* (mm)	C* (mm)	D* (mm)	T (mm)	Capacity (Litres)			Recessed Holes			
						(kg)	Z2 (total)	Z3 (water)	No.	E (Ø mm)	F (mm)	G (mm)
H160	162	140	160	63	2.0	0.98	1.80	0.80	2	9.5	80	56
H200	200	160	180	71	2.0	1.30	2.84	1.29	2	11.5	125	63
H250	253	182	200	80	2.0	1.71	4.45	2.06	3	11.5	80	71
H315/2.0	315	202	224	90	2.0	2.40	6.50	3.20	3	11.5	112	80
H315/3.0	315	202	224	90	3.0	3.60	6.50	3.20	3	11.5	112	80
H400/2.0**	407	240	275	113	2.0	4.00	13.40	6.50	4	11.5	100	90
H400/3.0**	407	240	275	113	3.0	6.00	13.40	6.50	4	11.5	100	90

* Note: Dimensions for H Types measured internally in accordance with DIN Norm / ** Not to DIN Norm

