

# TYPE D DEEP PATTERN

- Pressed Seamless Steel Bucket.
- For free flowing materials
  - For materials elevated at slower speeds with gravity discharge
  - Mainly for heavy duty applications

## PRESSED SEAMLESS STEEL

Industrial

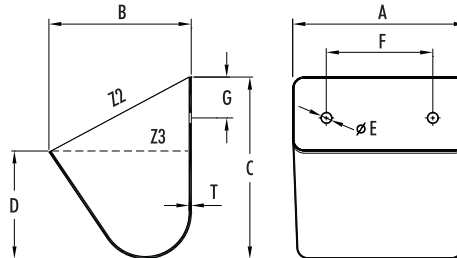

No.	A (mm)	B (mm)	C (mm)	D (mm)	T (mm)	Capacity (Litres)			Bolt Holes			
						(kg)	Z2 (total)	Z3 (water)	No.	E (Ø mm)	F (mm)	G (mm)
D21	203	127	146	86	3.0	1.50	2.10	1.35	To customer specification			
D55	229	152	200	111	3.0	2.59	3.95	2.40				
D58	254	152	200	111	2.0	1.84	4.40	2.65				
D61	254	152	200	111	3.0	2.59	4.40	2.65				
D64	279	152	200	111	3.0	2.77	4.85	3.00				
D66	305	152	200	111	1.5	1.54	5.20	3.20				
D69	305	152	200	111	3.0	3.02	5.20	3.20				
D70	305	152	200	111	4.7	4.74	5.20	3.20				
D96	356	184	229	108	3.0	3.99	7.80	4.35				
D120	457	191	254	133	4.7	9.00	12.20	7.65				
D160	406	197	244	140	3.0	5.17	10.75	7.20				
D180	406	197	244	140	4.7	7.89	10.75	7.20				
D123	508	203	273	149	4.7	10.54	15.25	9.25				
D131	619	210	298	127	3.0	7.80	20.00	9.50				
D181	381	222	254	140	4.7	7.94	12.15	7.35				

Free Engineering Design Service - contact 4B or visit: [www.go4b.com](http://www.go4b.com)

