

TYPE A SHALLOW PATTERN



- Pressed Seamless Steel Bucket. > For sticky materials at slow speeds
> For free flowing materials at higher speeds and closer spacing

PRESSED SEAMLESS STEEL

Agricultural

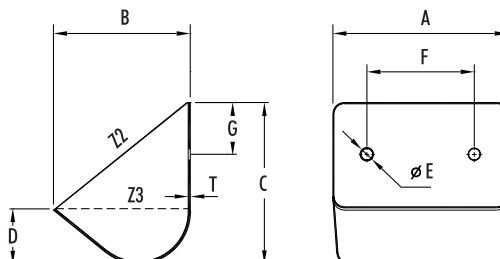
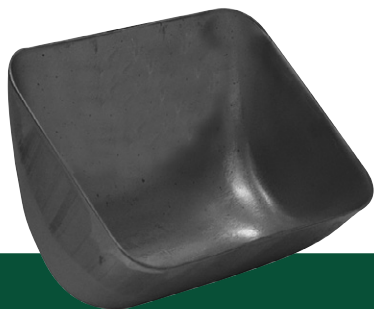

No.	A (mm)	B (mm)	C (mm)	D (mm)	T (mm)	Capacity (Litres)			Bolt Holes			
						(kg)	Z2 (total)	Z3 (water)	No.	E (Ø mm)	F (mm)	G (mm)
A29	152	108	124	38	1.2	0.39	0.96	0.34	To customer specification			
A32	178	108	124	38	1.5	0.57	1.20	0.44				
A59	229	121	143	48	3.0	1.70	1.88	0.75				
A69	254	149	187	67	3.0	2.31	3.65	1.47				
A72	305	168	229	86	3.0	3.27	3.24	2.50				

Free Engineering Design Service - contact 4B or visit: www.go4b.com



LOOKING FOR A REPLACEMENT ELEVATOR BUCKET?

Send us the bucket measurements and ideally a picture – and we'll find the matching bucket for you.